

THEFT DETERRENT SYSTEM

1. General

- This system has been provided as optional equipment on all models.
- The theft deterrent system uses the door lock control system and wireless door lock remote control system parts. The theft deterrent system will operate when somebody attempts to forcibly enter the vehicle, open the engine hood, or when the battery terminals are removed and reconnected.
- The control of this system is effected by the theft deterrent ECU, which maintains communication via the body ECU and BEAN (Body Electronics Area Network).
- An intrusion sensor has been adopted on the Europe model. This sensor improves the system performance in case an attempt is made to enter the vehicle by breaking a window glass.
- The warning specifications of this system are listed below.

Warning Specifications ◀

Destination	Europe	Other
Warning Method	Interior Light	Illuminates ←
	Hazard Light	Flashing ←
	Headlights	— Flashing
	Taillights	— Flashing
	Vehicle Horn	Sounds a warning at approx. 0.4 second cycles ←
	Security Horn	— Sounds a warning at approx. 0.4 second cycles
	Self Power Siren	Sounds a warning at the cycle of the self-powered siren itself ←
	Door Lock Motor	Locking ←
Warning Time		27.5 sec. ←

2. System Diagram

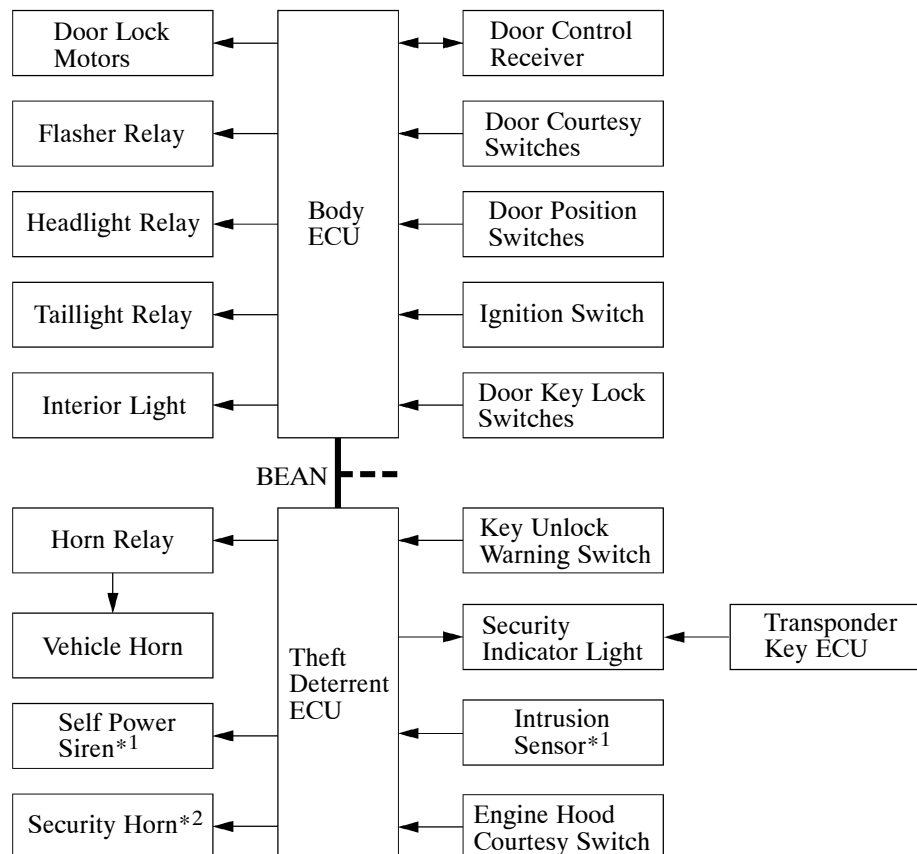

*1: Only for Europe Model

*2: except Europe Model

3. Layout of Main Component

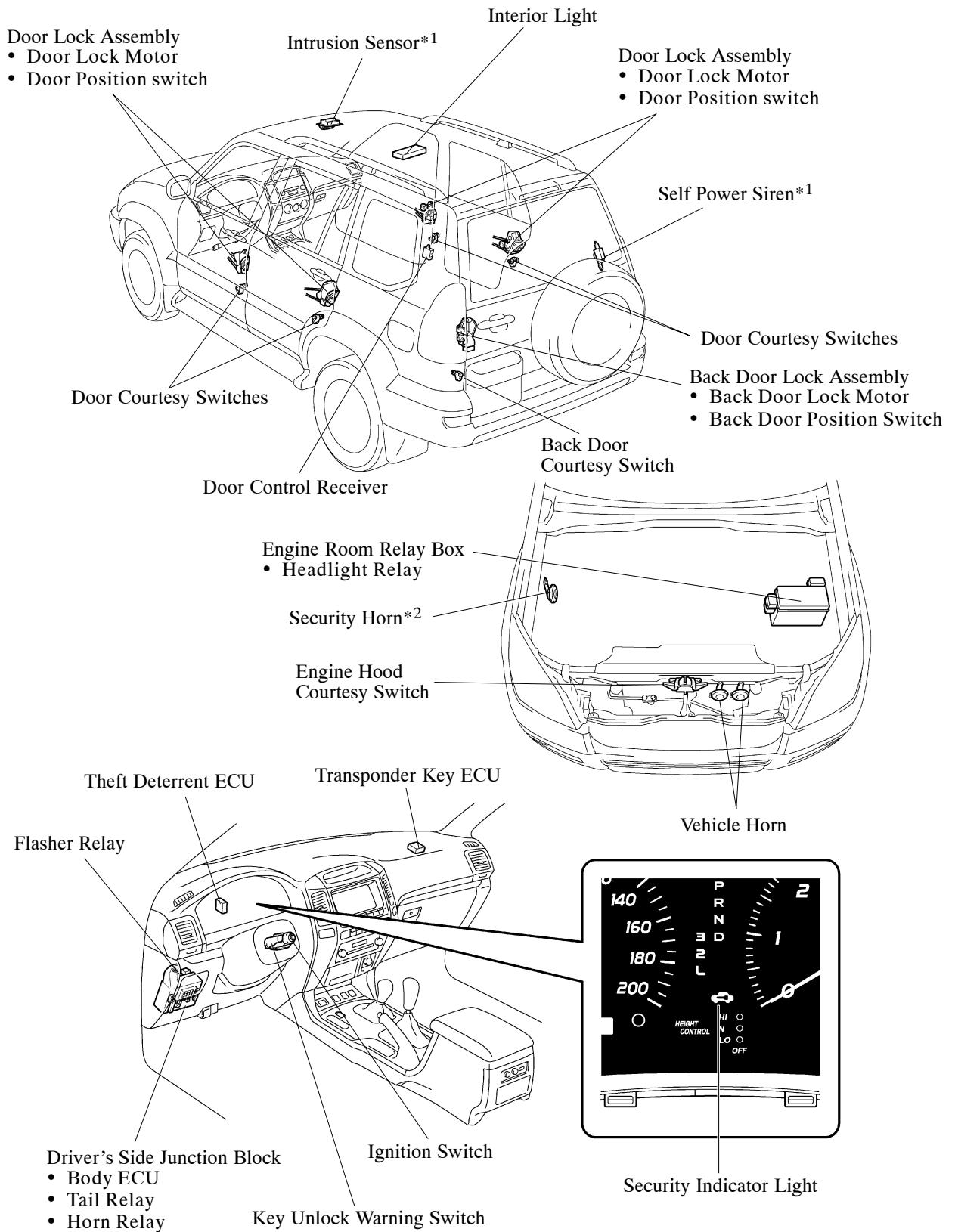

*1: Only for Europe Model

*2: except Europe Model

4. Construction and Operation

Intrusion Sensor

1) General

- An intrusion sensor is provided in the front interior light located in the front of the vehicle interior.
- The intrusion sensor contains an ultrasonic sensor that transmits and receives ultrasonic waves. The intrusion sensor detects an intruder through the conditions of the ultrasonic waves and transmits a signal to the theft deterrent ECU.

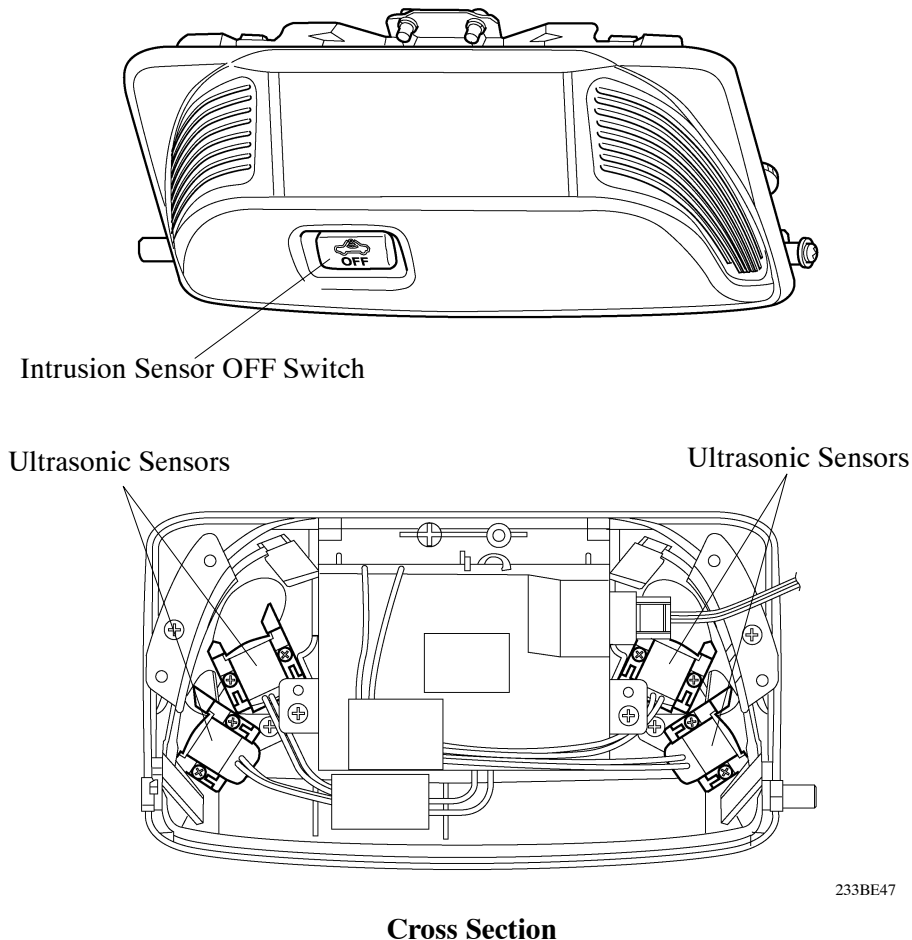

2) Operation

- The theft deterrent ECU activates the intrusion sensor when the system changes from the disarmed state to the armed preparation state. If an intrusion detection signal is input from the intrusion sensor during the armed state, the ECU changes to the alarm state in order to output an alarm.
- When the system is in the disarmed state, the function of the intrusion sensor can be disabled by pressing the intrusion sensor OFF switch. If the system changes from this state to the armed preparation state, the intrusion sensor will not activate. This function is canceled each time all doors are unlocked with a transmitter, and is reinstated when the intrusion sensor is ON.

5. System Operation

Basic Operation

This system activates as described in the diagram below when one of items place in the respective state.

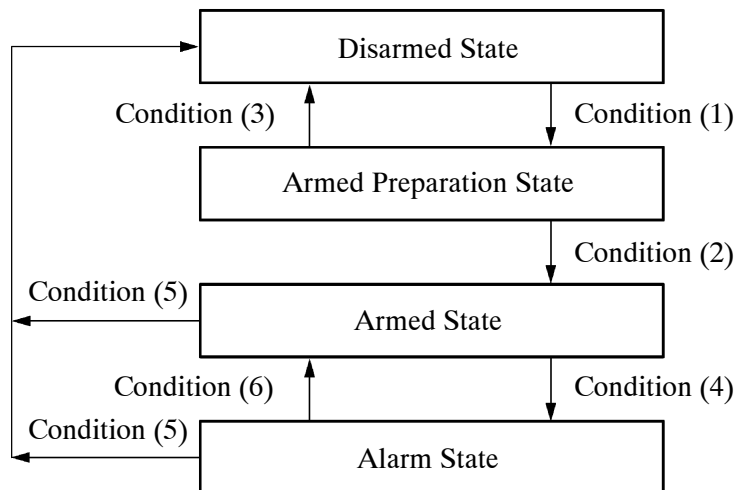

187BE40

Condition	Item
Condition (1)	<ul style="list-style-type: none"> There is no ignition key in the ignition key cylinder. When the doors, engine hood, and back door are all closed, the transmitter is used to lock all doors. When the doors, engine hood, and back door are all closed, the key is used to lock all doors. (Except models for Europe) When all the doors are locked, one of the doors, engine hood, or back door is changed from "open" to "close", and all the doors are locked and closed. (Except models for Europe)
Condition (2)	When the doors, engine hood, and back door are all closed and locked, and 30 seconds have elapsed.
Condition (3)	<ul style="list-style-type: none"> When one of the doors, engine hood, or back door is changed from "close" to "open". When one of the doors, engine hood, or back door is changed from "lock" to "unlock". When the ignition key is inserted in the ignition key cylinder. When a terminal is disconnected from the battery and reconnected.
Condition (4)	<ul style="list-style-type: none"> Any door, engine hood, or back door is opened. Any door is unlocked with something other than the ignition key (Except models for Europe) or transmitter. The engine hood is opened. A terminal is disconnected from the battery and reconnected. The wiring harness is directly connected as if the turn the ignition switch ON. The intrusion sensor has detected an intruder.
Condition (5)	<ul style="list-style-type: none"> The transmitter is used to unlock the doors. The ignition key is used to unlock the doors. (Except models for Europe) The key is inserted in the ignition key cylinder and the ignition switch is turned ON. (Except models for Europe)
Condition (6)	After approximately 30 seconds of the alarm time have elapsed.

Forced Door Lock Operation

When the system starts the alarm state, and one of the doors is subsequently unlocked, the forced door lock operation forcefully outputs a door lock signal to prevent intrusion into the vehicle. This operation becomes activated when all the starting conditions listed below have been met, and stops when one of the stopping conditions occurs.

Condition	Item
Starting Condition	The theft deterrent system is in the alarm state.
	There is no key inserted in the ignition key cylinder.
	If one of the doors is unlocked.
Stopping Condition	All doors are locked.
	The warning ends.
	The ignition key is inserted in the ignition key cylinder.